

Outdoor unit with R-407C

RMX

Super multi plus

It is possible to connect up to 7 indoor units to a single outdoor unit.
The indoor units may be of different types and even different capacities.
Both inverter and non-inverter units can be connected.

FHYC



FVX



FTX(D)



FHYB



FLX

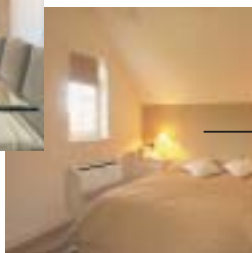

CDX

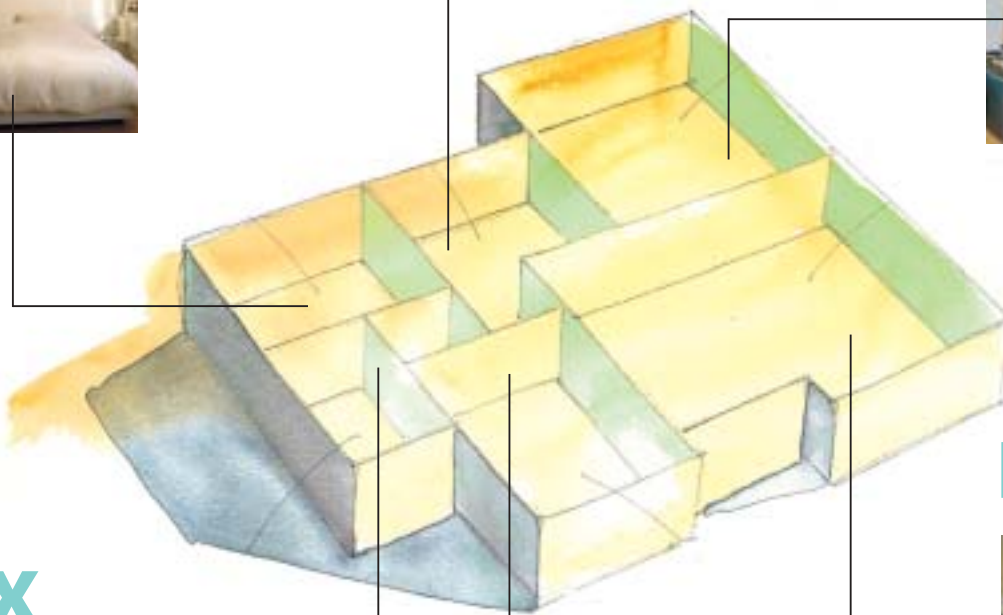

Features

- Reduced indoor sound level compared to VRV systems, thanks to the use of a BP (Branch Provider), containing the expansion valves
- Less piping needed in comparison to a standard multi system, because of the use of the Branch Provider
- No need for power supply on the indoor unit side
- Chargeless piping up to 115 meters
- This new unit incorporates the advanced Daikin PAM inverter technology.
The application of this unique facility, results in improved cooling and heating performance combined with lower energy consumption and minimum operating sound levels. Since air conditioning supply is regulated according to outside temperature, internal setpoint temperature and room size, power consumption is up to 30% less than that of similar non-inverter controlled versions.

MIO control (Multi Input and Output)

- leads to more comfort than using fuzzy logic
- Improving performance of system convergence and start -up
= Realizes greater comfort than that by fuzzy control =
- Comparison between conventional control and MIO control
Efficiency of control over discharge temperature and superheat degree upon switching fan air flow rates.

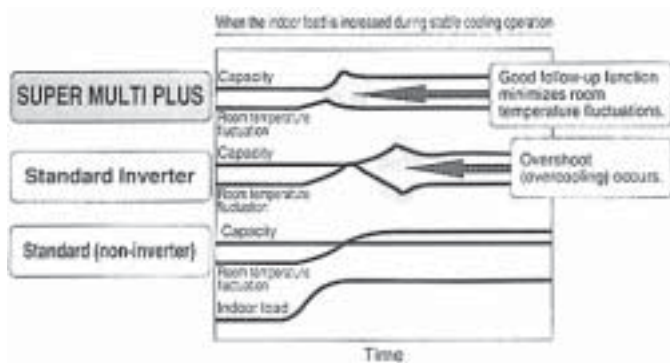

The expansion valve and compressor are separately controlled in a conventional inverter model, therefore when room temperature varies they often result in overshoot and require some time to stabilize temperature.

The MIO control is a very innovative method to simultaneously output multiple signals based on multiple pieces of input information. This allows the air conditioner to quickly respond to changes in the room temperature to create a comfortable ambience.

- MIO control ensures much higher stability of discharge temperature and superheat degree than conventional control methods.

Branch provider unit

Branch Provider Unit-BPMK = Unit for Variable Refrigerant Volume System =

- Features
 - Quiet Operation (reduced refrigerant running noise of indoor unit)
 - Brazed Piping
 - No need of drain disposal



For 2 rooms : RMX140J
BPMK928B42
For 3 rooms : BPMK928B43

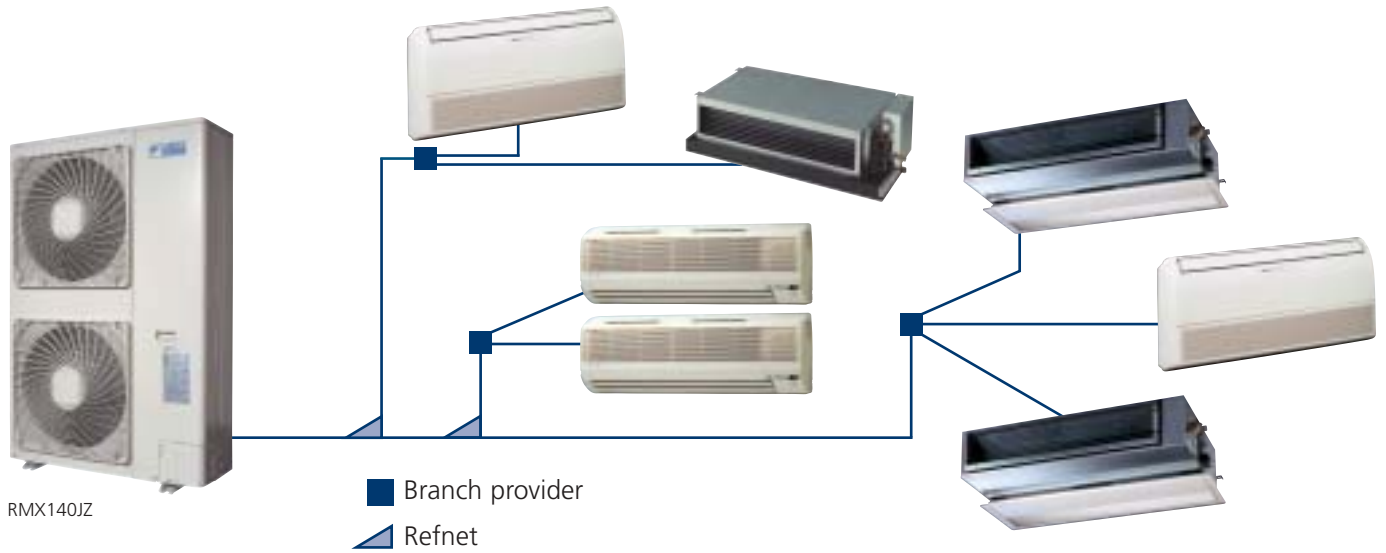

CONNECTABLE INDOOR UNITS

Class	FTX25JAV1NB	FVX25KZV1B	FLX25HV1NB	CDX25JV1NB	FHYB35FK7V1	FHYC35B7V1
25 class	FTX25JAV1NB	FVX25KZV1B	FLX25HV1NB	CDX25JV1NB	-	-
35 class	FTX35JAV1NB	FVX35KZV1B	FLX35HV1NB	CDX35JV1NB	FHYB45FK7V1	FHYC45B7V1
45 class	-	-	-	-	-	-
50 class	FTXD50JV1B	-	FLX50JV1B	CDX50JV1NB	-	-
60 class	FTXD60JV1B	-	FLX60JV1B	CDX60JV1NB	FHYB60FK7V1	FHYC60B7V1
71 class	FTXD71JV1B	-	-	-	FHYB71FK7V1	FHYC71B7V1

HEAT PUMP

INDOOR UNIT			FTX25JAV1NB	FTX35JAV1NB	FTXD50JV1B	FTXD60JV1B	FTXD71JV1B
Dimensions	HxWxD	mm	273x784x185		298x1,050x190		
Weight		kg	75		12		
Air flow rate (H/L)	cooling	m ³ /min	71/4.6	74/4.7	12.3/9.1	13.0/9.9	13.7/9.9
	heating	m ³ /min	8.4/5.7	8.4/5.9	14.9/10.5	16.5/11.1	17.3/11.1
Sound pressure level (H/L)	cooling	dB(A)	38/26	39/27	44/35	45/37	46/37
	heating	dB(A)	38/26	39/27	42/32	44/34	46/34
Sound power level (H)	cooling	dB(A)	54	55	60	61	62
	heating	dB(A)	54	55	58	60	62
Infrared remote control			ARC423A1		ARC417A14		

INDOOR UNIT			FVX25KZV1B	FVX35KZV1B
Dimensions	HxWxD	mm	600x650x195	
Weight		kg	13	
Air flow rate (H/L)	cooling	m ³ /min	81/4.3	83/4.3
	heating	m ³ /min	9.2/4.8	9.2/5.0
Sound pressure level (H/L)	cooling	dB(A)	38/26	39/26
	heating	dB(A)	38/26	39/26
Sound power level (H)	cooling	dB(A)	50	51
	heating	dB(A)	50	51
Infrared remote control			ARC417A16	

INDOOR UNIT			FLX25HV1NB	FLX35HV1NB	FLX50JV1B	FLX60JV1B
Dimensions	HxWxD	mm	490x1,050x200			
Weight		kg	16		17	
Air flow rate (H/L)	cooling	m ³ /min	7.6/6.0	8.7/6.6	11.4/8.5	12.0/9.3
	heating	m ³ /min	9.2/7.4	10.0/8.0	12.1/7.5	12.8/8.4
Sound pressure level (H/L)	cooling	dB(A)	37/31	38/32	47/39	48/41
	heating	dB(A)	37/31	39/33	46/35	47/37
Sound power level (H)	cooling	dB(A)	50	51	63	64
	heating	dB(A)	50	52	62	63
Infrared remote control			ARC423A7		ARC423A15	

INDOOR UNIT				CDX25JV1NB	CDX35JV1NB	CDX50JV1NB	CDX60JV1NB
Dimensions		HxWxD	mm	260x900x580			
Weight			kg	23		24	
Air flow rate (H/L)	cooling		m ³ /min	13.0/11.0	13.0/11.0	13.0/11.0	14.5/11.5
	heating		m ³ /min	13.0/11.0	13.0/11.0	13.0/11.0	14.5/11.5
Sound pressure level (H/L)	cooling		dB(A)	39/36	39/36	42/39	44/41
	heating		dB(A)	40/36	40/36	42/38	44/40
Sound power level (H)	cooling		dB(A)	55	55	58	60
	heating		dB(A)	56	56	58	60
Infrared remote control				ARC423A11			

INDOOR UNIT				FHYB35FK7V1	FHYB45FK7V1	FHYB60FK7V1	FHYB71FK7V1
Dimensions	unit	HxWxD	mm	300x700x800		300x1,000x800	
Weight	unit		kg	55		55	
Air flow rate (H/L)	cooling		m ³ /min	11.5/9	14/10	17/13	19/14
	heating		m ³ /min	11.5/9	14/10	17/13	19/14
Sound pressure level (H/L)	cooling		dB(A)	33/29	33/29	34/30	34/30
	heating		dB(A)	33/29	33/29	34/30	34/30
Sound power level (H)	cooling		dB(A)	52	53	60	60
	heating		dB(A)	52	53	60	60
Wired remote control				BRC1D517			
DECORATION PANEL				BYB545DJW18		BYB571DJW18	
Dimensions	decoration panel	HxWxD	mm	55x880x500		55x1,100x500	
Weight	decoration panel		kg	3.5		4.5	

INDOOR UNIT				FHYC35B7V1	FHYC45B7V1	FHYC60B7V1	FHYC71B7V1
Dimensions	unit	HxWxD	mm	230x840x840			
Weight	unit		kg	23			
Air flow rate (H/L)	cooling		m ³ /min	14/10	15/11	18/14	18/14
	heating		m ³ /min	14/10	15/11	18/14	18/14
Sound pressure level (H/L)	cooling		dB(A)	31/27	31/27	33/28	33/28
	heating		dB(A)	31/27	31/27	33/28	33/28
Sound power level (H)	cooling		dB(A)	48	48	50	50
	heating		dB(A)	48	48	50	50
Wired remote control				BRC1D517			
DECORATION PANEL				BYC125KJW1			
Dimensions	decoration panel	HxWxD	mm	40x950x950			
Weight	decoration panel		kg	5			

OUTDOOR UNIT				RMX140JZVMB
Dimensions		HxWxD	mm	1,350x880x320
Weight			kg	136
Sound pressure level (H)	cooling		dB(A)	53
	heating		dB(A)	53
Sound power level (H)	cooling		dB(A)	66
	heating		dB(A)	66
Operation range	cooling		°CDB	-5 ~ 46
	heating		°CWB	-15 ~ 15.5
Refrigerant type				R-22/R-407C
Power supply	VM			1 ~ 220-240/220-230V, 50/60Hz

BP-UNIT

				BPMK928B42	BPMK928B43
Connectable indoor units				1 ~ 2	1 ~ 3
Power input				0.01	0.01
Dimensions		HxWxD	mm	223x400x272	
Weight				7	8