

# 1 Features

1  
1

- Comfort mode reassures draught-free operation
- Vertical auto-swing function moves the discharge flaps up and down for efficient air distribution throughout the room
- You have the choice out of 5 fan speeds to select
- Daikin's special dry programme reduces humidity in the room without variation in room temperature
- Night set mode saves energy by preventing overcooling or overheating during night time
- Powerful mode can be selected for rapid cooling
- Indoor unit silent operation: "Silent" button on the remote control lowers the operation sound of the indoor unit by 3dB(A).
- The new titanium apatite photocatalytic air purification filter increases the active surface area for effective purification and deodorisation
- ECONO mode decreases power consumption so that other appliances that need large power supply can be used
- The movement sensor saves power consumption in unoccupied rooms



								
			optional					
								
5 steps		standard						
			(integrated titanium apatite)					

## 2 Specifications

2-1 TECHNICAL SPECIFICATIONS				CTKS50DVMW	
Casing	Colour			White	
Dimensions	Packing	Height	mm	340	
		Width	mm	855	
		Depth	mm	265	
	Unit	Height	mm	283	
		Width	mm	800	
		Depth	mm	195	
Weight	Machine Weight		kg	9.0	
	Gross Weight		kg	12.0	
Heat Exchanger	Dimensions	Length	mm	610	
		Nr of Rows		2	
		Fin Pitch	mm	1.40	
		Nr of Stages		14	
	Tube type		Hi-XA (7)		
	Fin	Type		ML fin (Multi louver)	
Air Flow Rate	Cooling	High	m <sup>3</sup> /min	11.4	
		Medium	m <sup>3</sup> /min	9.3	
		Low	m <sup>3</sup> /min	7.1	
		Silent Operation	m <sup>3</sup> /min	6.2	
Fan	Motor	Quantity		1	
		Model		KFD-280-40-8B	
		Number of steps		5 steps, silent and auto	
Motor	Speed (cooling)	High	rpm	1620	
		Medium	rpm	1350	
		Low	rpm	1090	
		Silent Operation	rpm	980	
Fan	Motor	Output (high)	W	40	
Cooling	Sound Power	High	dBA	64.0	
		Low	dBA	35.0	
	Sound Pressure	High	dBA	46.0	
		Silent Operation	dBA	32.0	
Refrigerant	Type			R-410A	
Piping connections	Liquid (OD)	Diameter (OD)	mm	6.4	
	Gas	Diameter (OD)	mm	12.7	
	Drain	Diameter (OD)	mm	18	
	Heat Insulation			Both liquid and gas pipes	
Air Filter			Removable/washable/Mildew proof		
Air direction control			Left, right, up and downwards		
Temperature control			Microcomputer control		

1  
2

2-1 TECHNICAL SPECIFICATIONS		CTKS50DVMW	
Standard Accessories	Item	Titanium apatite photocatalytic air purification filter	
	Quantity	2	
	Item	Operation manual	
	Quantity	1	
	Item	Installation manual	
	Quantity	1	
	Item	Infrared remote control	
	Quantity	1	
	Item	Batteries	
	Quantity	2	
	Item	Remote control holder	
	Quantity	1	
	Item	Indoor unit fixing screws	
	Quantity	2	
	Item	Mounting plate	
Quantity	1		
Notes		Sound values are measured in an anechoic room.	
		Sound pressure level is a relative value, depending on the distance and acoustic environment. For more details, please refer to sound level drawings of this chapter.	
		The sound power level is an absolute value indicating the power which a sound source generates.	

2-2 ELECTRICAL SPECIFICATIONS			CTKS50DVMW	
Power Supply	Name		9	
	Phase		1	
	Frequency	Hz	50/60	
	Voltage	V	220-240/220-230	
Wiring connections	For Power Supply	Quantity	3	
		Remark	4 for interunit wiring (included earth wiring)	
Voltage range	Minimum		-10%	
	Maximum		+10%	
Power Supply Intake			Outdoor unit only	

NOTES

### 3 Dimensional drawing & centre of gravity

#### 3 - 1 Dimensional drawing

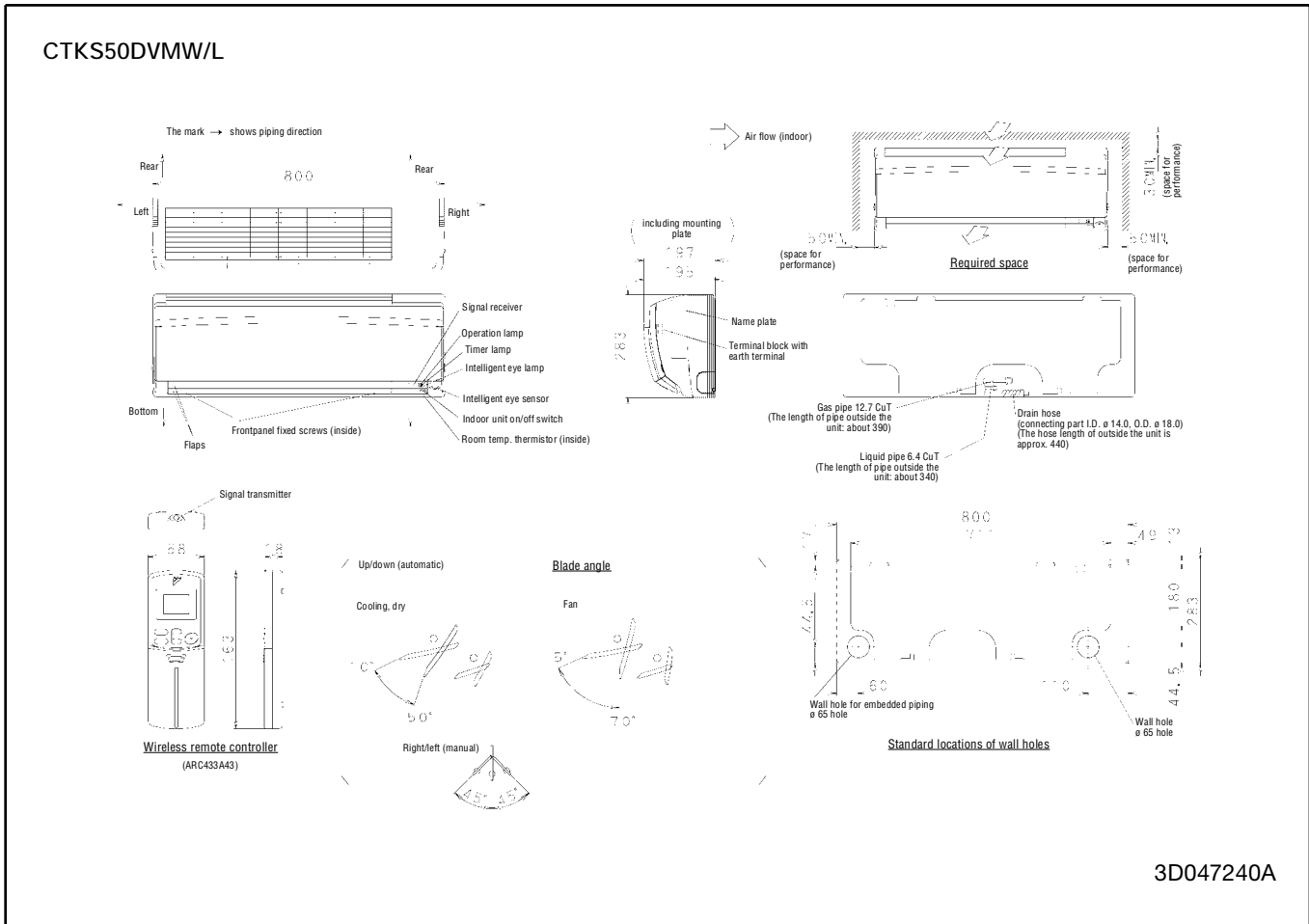

### 3 - 2 Centre of gravity

CTK/XS50DVMW/L

1

3

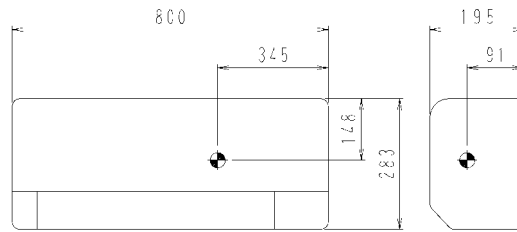

4D048210

# 4 Piping diagram

CTK/XS50DVMW/L

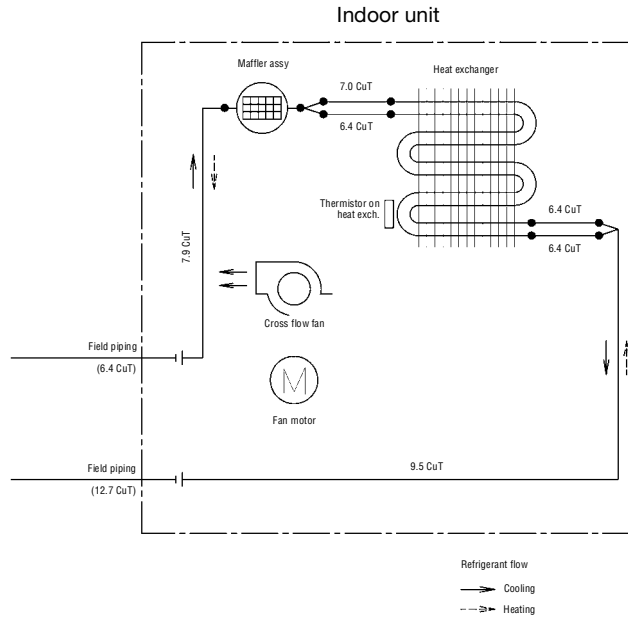

4D047913

# 5 Wiring diagram

## 5 - 1 Wiring diagram

1  
5

CTK/XS50DVMW/L

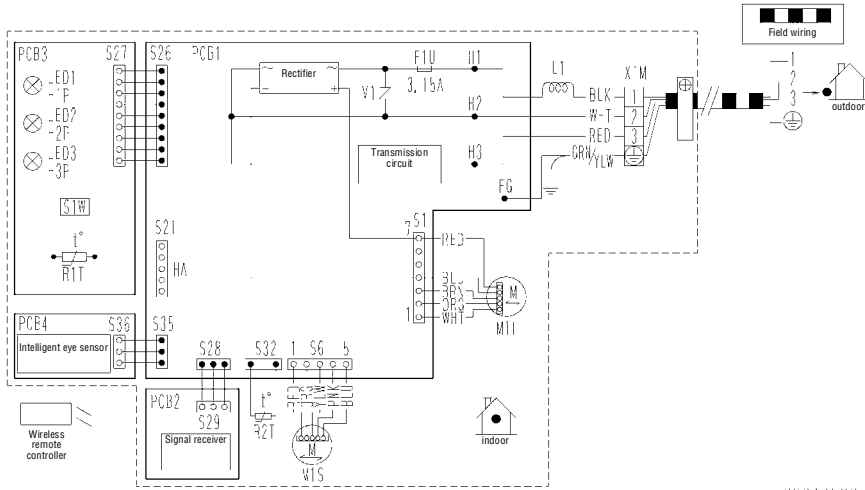

### LEGEND

⊕	Protective earth
FG	Frame ground
F1U	Fuse
H1P~H3P	Pilot lamp
L1	Coil
M1F	Fan motor
M1S	Swing motor
PCB1~PCB4	Printed circuit board
R1T, R2T	Thermistor
S1~S38	Connector
S1W	Operation switch
X1M	Terminal strip

### NOTES

- 1 Size: length 70 x width 120.
- 2 Refer to purchasing specification AS303002, unless otherwise specified.
- 3 This drawing was drawn on CAD system.
- 4 Caution: Note that operation will restart automatically if the main power supply is turned off and then back on again.

3D047523

## 6 Sound data

### 6 - 1 Sound pressure spectrum

